

Product Features

- High tin low calcium alloy grids designed to resist corrosion;
- Patent multi-layer polarity sealing structure, safety and reliable leakage-proof performance;
- Patent composite grid structure and plate of high humidity and high temperature curing process which prolong life;
- High purity row and auxiliary materials, low self discharge.

Application

- UPS/EPS
- Emergency lighting
- Communication equipment;
- Renewable Energy
- Power tool
- Universal

Compliant Standards

- GB/T 19639.1-2005;
- IEC 61056-1/2: 2002
- JIS C8702-1/2: 2009;
- Passed ISO9001, ISO14001, OHSAS18001, UL and CE certificates

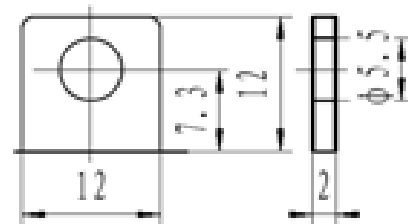
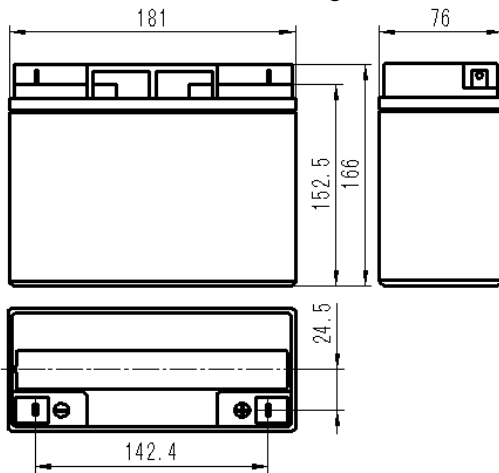

SP-11

Battery Model	SSP12-18			
Designed Life	5 Years			
Capacity(25°C)	20HR(0.9A,1.75V)	10HR(1.67A,1.75V)	5HR(3.3A,1.75V)	1HR(11.52A,1.70V)
	18Ah	16.7AH	16.5AH	11.52AH
Dimensions	Length	Width	Height	Total Height
	181mm	76mm	166mm	166mm
Approx. Weight	5.3kg			
Internal Resistance	16mΩ			
Maximum Discharge Current	270A(5 Sec.)			
Self Discharge	≤3% per months (25°C)			
Charge Voltage(25°C)	Cycle use		Float use	
	14.7V(-18mV/°C), max charge current:5.4A		13.62V(-18mV/°C)	

Discharge parameter:

Constant current discharge data (25°C, A)													
End voltage (V/cell)	5min	10min	15min	20min	30min	45min	1h	1.5h	2h	3h	5h	10h	20h
1.60	79.24	46.41	34.18	27.33	19.88	14.76	11.72	8.581	6.900	5.096	3.287	1.709	0.918
1.65	77.67	44.75	33.28	26.83	19.54	14.63	11.57	8.473	6.820	5.032	3.258	1.694	0.911
1.70	75.17	42.83	32.69	26.45	19.28	14.40	11.44	8.391	6.753	4.987	3.233	1.684	0.905
1.75	62.64	38.45	30.96	25.38	18.65	13.92	11.20	8.251	6.660	4.938	3.204	1.670	0.900
1.80	54.50	35.18	28.89	24.03	17.90	13.46	10.94	8.110	6.567	4.879	3.169	1.655	0.895

Constant power discharge data (25°C, W/cell)													
End voltage (V/cell)	5min	10min	15min	20min	30min	45min	1h	1.5h	2h	3h	5h	10h	20h
1.60	138.6	84.61	64.37	52.36	38.43	28.79	23.00	16.89	13.62	10.10	6.537	3.405	1.834
1.65	138.5	82.45	63.12	51.57	37.90	28.61	22.76	16.73	13.50	9.997	6.492	3.383	1.823
1.70	136.5	79.60	62.39	50.99	37.50	28.23	22.55	16.61	13.40	9.930	6.455	3.370	1.816
1.75	115.3	72.03	59.37	49.13	36.41	27.38	22.12	16.37	13.24	9.850	6.412	3.349	1.808
1.80	101.1	66.55	55.68	46.75	35.06	26.53	21.68	16.12	13.09	9.749	6.353	3.326	1.800

All data on the spec. sheet is an average value:

The tolerance range: $X < 6\text{min}$ (+15%~-15%), $6\text{min} \leq X < 10\text{min}$ (+12%~-12%), $10\text{min} \leq X < 60\text{min}$ (+8%~-8%), $X \geq 60\text{min}$ (+5%~-5%)

Performance Curve:

