

Product Features

- Special negative active material additives improved battery high and low temperature performance and charge acceptance ability;
- Special 4BS additives and high temperature curing process make battery have long cycle life;
- Compact assembly technology, effectively prevent the active material softening and shedding;
- Patent waterproof terminal structure design, suitable for underground use.

Application

- Power supply system for solar energy and wind energy;
- Solar energy/wind energy street lamp, signal lamp;
- Frontier sentry Island garrison power supply system
- Remote monitoring system, and base station

Compliant Standards

- GB/T 19639.1-2005;
- GB/T 22473-2008
- IEC 61427-2005
- Passed ISO9001、ISO14001、OHSAS18001 certificates
- Eurobat guide;

Safety

- installation compliant with:EN50272-2

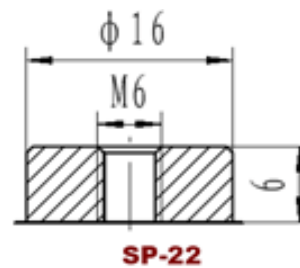
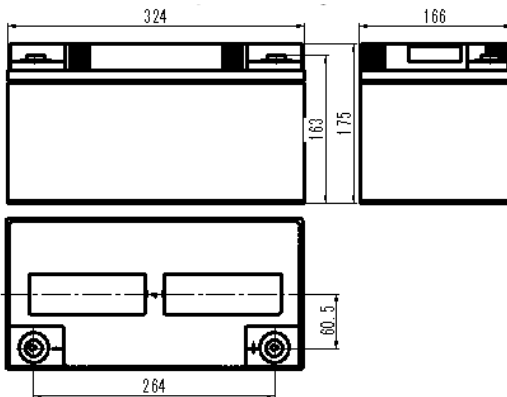

Battery Model	SPU12-70			
Designed Life	10 Years			
Capacity(25°C)	20HR(3.57A,1.80V)	10HR(7.0A,1.80V)	5HR(11.02A,1.80V)	3HR(16.52A,1.80V)
	71.4AH	70.0AH	55.1AH	49.56AH
Dimensions	Length	Width	Height	Total Height
	324mm	166mm	175mm	175mm
Approx. Weight	21.7kg			
Internal Resistance	6.0m Ω			
Short Circuit Current	2000A			
Self Discharge	$\leq 2\%$ per months (25°C)			
Charge Voltage(25°C)	Cycle use ($\leq 20\%$ DOD)		Cycle use ($> 20\%$ DOD)	
	14.2V(-24mV/°C), max charge current:17.5A		14.6V(-24mV/°C)	

Discharge parameter:

Constant current discharge data (25°C, A)								
End voltage (V/cell)	3h	5h	10h	20h	50h	100h	120h	240h
1.70	17.50	11.33	7.185	3.643	1.465	0.780	0.680	0.361
1.75	17.08	11.20	7.108	3.628	1.461	0.774	0.675	0.359
1.80	16.52	11.02	7.000	3.570	1.442	0.770	0.671	0.356
1.85	15.82	10.60	6.722	3.454	1.404	0.749	0.654	0.348
1.90	14.70	9.856	6.258	3.207	1.307	0.706	0.618	0.327
1.95	12.74	8.386	5.316	2.728	1.111	0.599	0.526	0.280

Constant power discharge data (25°C, W)								
End voltage (V/cell)	3h	5h	10h	20h	50h	100h	120h	240h
1.70	32.20	21.63	13.88	7.172	2.916	1.553	1.356	0.731
1.75	31.78	21.45	13.80	7.158	2.910	1.549	1.354	0.731
1.80	31.08	21.21	13.65	7.086	2.889	1.549	1.353	0.729
1.85	30.10	20.50	13.15	6.872	2.818	1.510	1.319	0.713
1.90	28.42	19.17	12.26	6.399	2.625	1.424	1.250	0.672
1.95	25.06	16.52	10.44	5.454	2.237	1.211	1.064	0.577

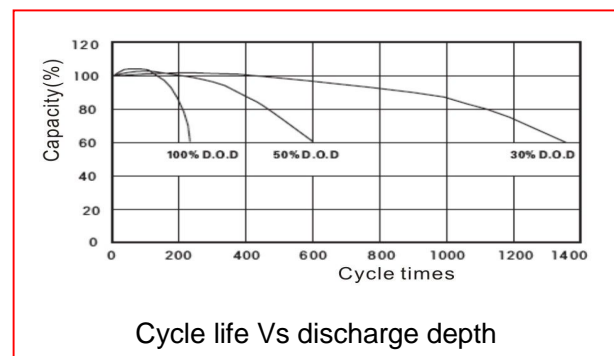
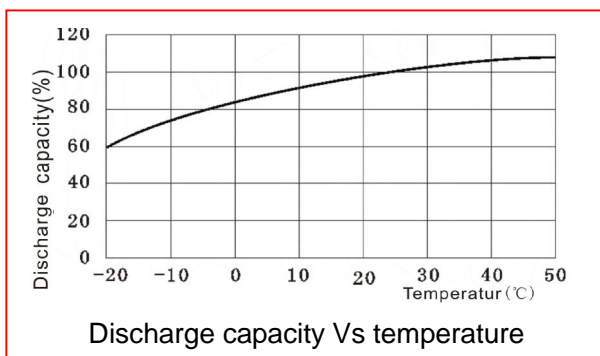
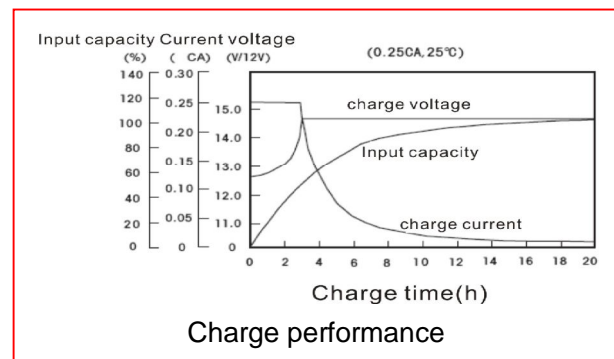
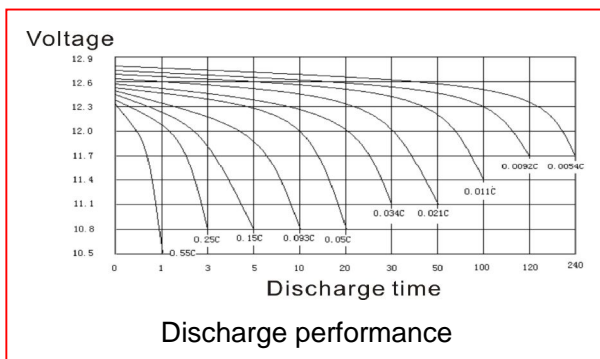
Performance Curve:

Address: NO.1 Shengyang Road, Qufu, Shandong 273100 China

Tel: +86-537-4438666-6028

Fax: +86-537-4411936

E-mail: sales@sacredsun.cn

<http://www.sacredsun.com>