

Product Features

- Patent rectangular gridding grid design which provide long service life;
- Special negative active material additives to improve the performance of high and low temperature and battery charge receptivity;
- Patent positive plate 4BS technology, high temperature and high humidity curing process which provide high cycle capability;
- Polar group tight assembly technology, effectively prevent the active material softening and shedding.

Application

- Solar energy system
- Wind energy system
- Wind and solar complementary energy system

Compliant Standards

- GB/T 22473-2008
- IEC 61427-2005
- JIS C8704-1: 2006
- JIS C8704-2: 2006
- Passed ISO9001、ISO14001、OHSAS18001、UL、CE and Golden Sun certificate
- Eurobat guide;

Safety

- installation compliant with:EN50272-2

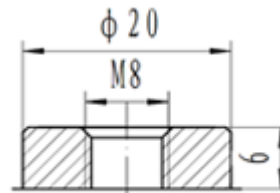
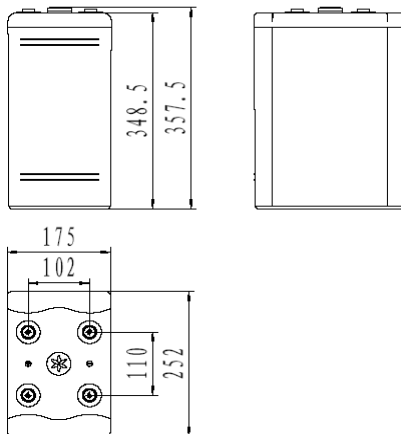

GFM-21

Battery Model	GFMU-600C			
Designed Life	15Years			
Capacity(25°C)	120HR(6.0A,1.85V)		20HR(30.6A,1.80V)	10HR(60A,1.80V)
	720AH		612AH	600AH
Dimensions	Length	Width	Height	Total Height
	252mm	175mm	348.5mm	357.5mm
Approx. Weight	36 kg			
Internal Resistance	0.36mΩ for fully charged battery at 25°C Test instrumentation: HIOKI 3551 BATTERY HITESTER (25			
Max Discharge Current	3000A(5 Sec.)			
Self Discharge	≤1% per months (25°C)			
Charge Voltage(25°C)	Cycle use		Float use	
	2.35V(-3.5mV/°C), max charge current:90A		2.25V(-3.5mV/°C)	

Discharge parameter:

Constant current discharge data (25°C, A)																	
End voltage (V/cell)	1h	2h	3h	4h	5h	6h	7h	8h	9h	10h	12h	20h	24h	48h	96h	120h	240h
1.75	330	207	152	123	103	90.1	80.3	72.6	66.4	60.4	50.8	31.0	26.5	14.2	7.40	6.16	3.14
1.80	316	200	150	121	102	89.1	79.3	71.9	65.7	60.0	50.0	30.6	26.2	14.0	7.35	6.08	3.12
1.85	292	189	142	114	98.9	86.5	77.1	70.1	64.4	59.2	49.3	30.2	25.9	13.8	7.32	6.00	3.10
1.90	272	176	134	109	95.0	83.5	74.7	68.2	63.1	58.1	48.6	29.8	25.6	13.6	7.29	5.92	3.08
1.95	245	164	126	105	91.2	80.6	72.7	66.5	61.9	57.2	47.9	29.4	25.4	13.5	7.26	5.84	3.06

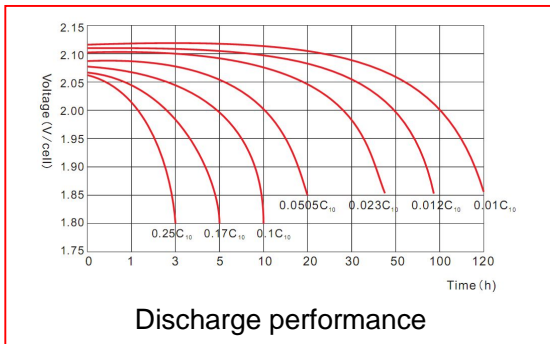
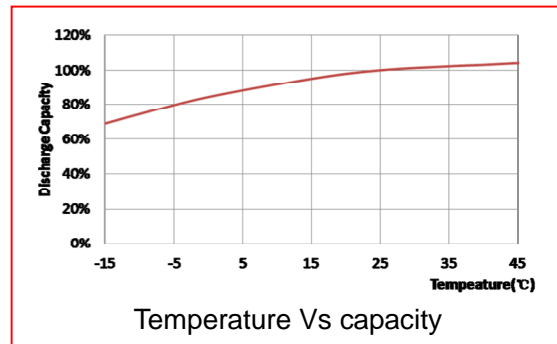
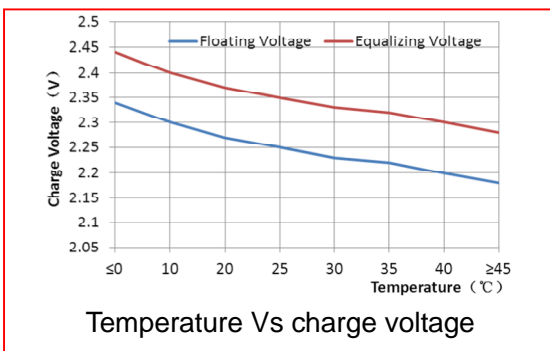
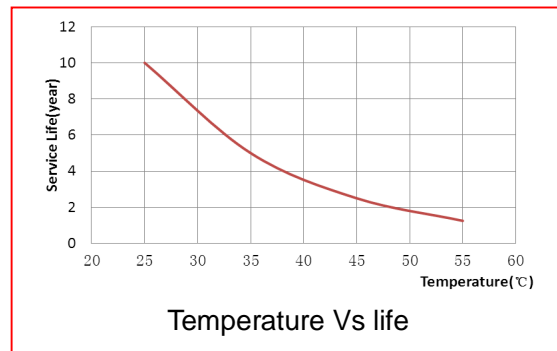
Constant power discharge data (25°C, W/cell)																	
End voltage (V/cell)	1h	2h	3h	4h	5h	6h	7h	8h	9h	10h	12h	20h	24h	48h	96h	120h	240h
1.75	547	361	273	220	188	166	151	137	125	114	97.5	61.5	53.0	27.8	14.3	11.9	6.22
1.80	522	351	267	216	185	164	149	135	123	113	96.5	61.0	52.6	27.7	14.3	11.8	6.19
1.85	501	339	260	211	181	161	146	134	121	111	95.4	60.5	52.3	27.6	14.2	11.7	6.16
1.90	479	329	253	207	177	158	143	131	119	108	94.3	60.0	51.9	27.4	14.2	11.7	6.14
1.95	453	317	246	202	172	155	141	128	116	106	92.7	59.7	51.6	27.4	14.1	11.6	6.12

Performance Curve:

Discharge performance

Temperature Vs capacity

Temperature Vs charge voltage

Temperature Vs life

Address: NO.1 Shengyang Road, Qufu, Shandong 273100 China

Tel: +86-537-4438666-6028

Fax: +86-537-4411936

E-mail: sales@sacredsun.cn

<http://www.sacredsun.com>