

Product Features

- Patent rectangular gridding grid design which provide long service life;
- Special negative active material additives to improve the performance of high and low temperature and battery charge receptivity;
- Patent positive plate 4BS technology, high temperature and high humidity curing process which provide high cycle capability;
- Polar group tight assembly technology, effectively prevent the active material softening and shedding.

Application

- Solar energy system
- Wind energy system
- Wind and solar complementary energy system

Compliant Standards

- GB/T 22473-2008
- IEC 61427-2005
- JIS C8704-1: 2006
- JIS C8704-2: 2006
- Passed ISO9001、ISO14001、OHSAS18001、UL、CE and Golden Sun certificate
- Eurobat guide;

Safety

- installation compliant with:EN50272-2

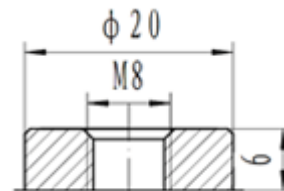
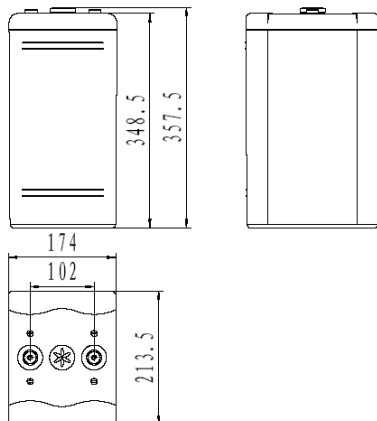

GFM-21

| | | | |
|-----------------------|---|-------------------|-----------------|
| Battery Model | GFMU-500C | | |
| Designed Life | 15Years | | |
| Capacity(25°C) | 120HR(5.0A,1.85V) | 20HR(25.5A,1.80V) | 10HR(50A,1.80V) |
| | 600AH | 510AH | 500AH |
| Dimensions | Length | Width | Height |
| | 213.5mm | 174mm | 348.5mm |
| Approx. Weight | 30.0kg | | |
| Internal Resistance | 0.34mΩ for fully charged battery at 25°C Test instrumentation: HIOKI 3551 BATTERY HITESTER (25 | | |
| Max Discharge Current | 2500A(5 Sec.) | | |
| Self Discharge | ≤1% per months (25°C) | | |
| Charge Voltage(25°C) | Cycle use | Float use | |
| | 2.35V(-3.5mV/°C), max charge current:75A | 2.25V(-3.5mV/°C) | |

Discharge parameter:

| Constant current discharge data (25°C, A) | | | | | | | | | | | | | | | | | |
|---|-----|-----|-----|------|------|------|------|------|------|------|------|------|------|------|------|------|------|
| End voltage (V/cell) | 1h | 2h | 3h | 4h | 5h | 6h | 7h | 8h | 9h | 10h | 12h | 20h | 24h | 48h | 96h | 120h | 240h |
| 1.75 | 275 | 173 | 127 | 103 | 85.8 | 75.1 | 66.9 | 60.5 | 55.3 | 50.3 | 42.3 | 25.8 | 22.1 | 11.8 | 6.17 | 5.13 | 2.62 |
| 1.80 | 263 | 167 | 125 | 101 | 85.0 | 74.3 | 66.1 | 59.9 | 54.8 | 50.0 | 41.7 | 25.5 | 21.8 | 11.7 | 6.13 | 5.07 | 2.60 |
| 1.85 | 243 | 158 | 118 | 95.0 | 82.4 | 72.1 | 64.3 | 58.4 | 53.7 | 49.3 | 41.1 | 25.2 | 21.6 | 11.5 | 6.10 | 5.00 | 2.58 |
| 1.90 | 227 | 147 | 112 | 90.8 | 79.2 | 69.6 | 62.3 | 56.8 | 52.6 | 48.4 | 40.5 | 24.8 | 21.3 | 11.3 | 6.08 | 4.93 | 2.57 |
| 1.95 | 204 | 137 | 105 | 87.5 | 76.0 | 67.2 | 60.6 | 55.4 | 51.6 | 47.7 | 39.9 | 24.5 | 21.2 | 11.3 | 6.05 | 4.87 | 2.55 |

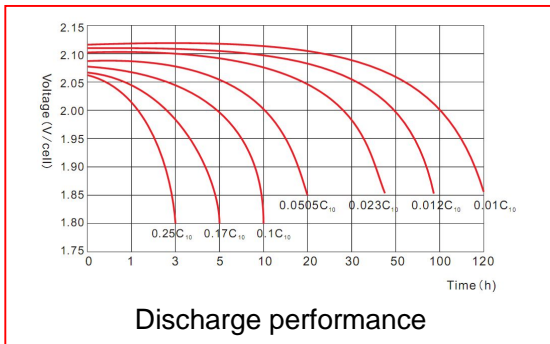
| Constant power discharge data (25°C, W/cell) | | | | | | | | | | | | | | | | | |
|--|-----|-----|-----|-----|-----|-----|-----|-----|------|------|------|------|------|------|------|------|------|
| End voltage (V/cell) | 1h | 2h | 3h | 4h | 5h | 6h | 7h | 8h | 9h | 10h | 12h | 20h | 24h | 48h | 96h | 120h | 240h |
| 1.75 | 456 | 300 | 227 | 183 | 157 | 139 | 126 | 114 | 104 | 95.2 | 81.3 | 51.3 | 44.2 | 23.2 | 11.9 | 9.88 | 5.18 |
| 1.80 | 435 | 292 | 223 | 180 | 154 | 136 | 124 | 113 | 103 | 94.2 | 80.4 | 50.8 | 43.8 | 23.0 | 11.9 | 9.82 | 5.16 |
| 1.85 | 417 | 283 | 217 | 176 | 151 | 134 | 122 | 111 | 101 | 92.2 | 79.5 | 50.5 | 43.6 | 23.0 | 11.8 | 9.78 | 5.14 |
| 1.90 | 399 | 275 | 211 | 172 | 147 | 132 | 120 | 110 | 98.8 | 90.1 | 78.6 | 50.0 | 43.2 | 22.8 | 11.8 | 9.73 | 5.12 |
| 1.95 | 377 | 264 | 205 | 168 | 144 | 129 | 117 | 107 | 96.8 | 88.5 | 77.3 | 49.7 | 43.0 | 22.8 | 11.8 | 9.68 | 5.10 |

Performance Curve:

Discharge performance

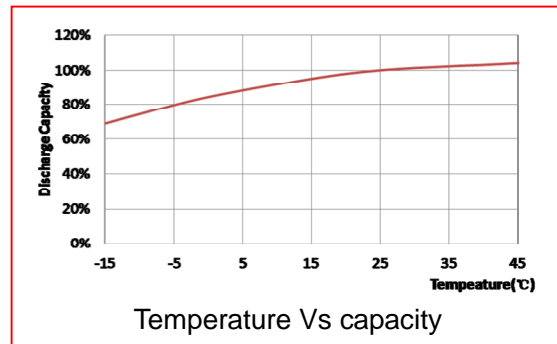

Temperature Vs capacity

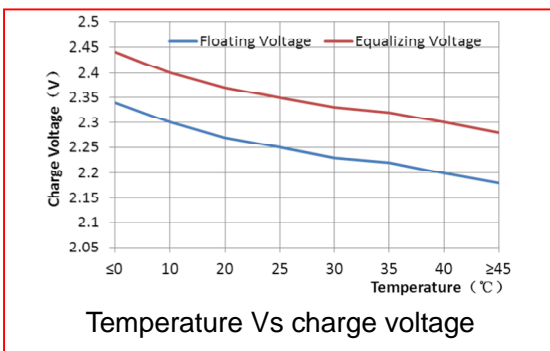

Temperature Vs charge voltage

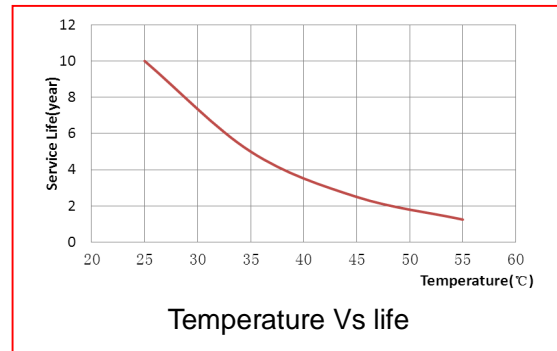

Temperature Vs life



Address: NO.1 Shengyang Road, Qufu, Shandong 273100 China

Tel: +86-537-4438666-6028

Fax: +86-537-4411936

E-mail: sales@sacredsun.cn

<http://www.sacredsun.com>