

Product Features

- Tubular positive plate avoids active material from shedding effectively and the positive frame is cast by multi-alloy(Pb-Ca-Sn-Al) with fine and compact crystal structure, resulting in good corrosion resistance;
- Sulfuric acid immobilized as a gel using the gaseous SiO₂ as main electrolyte, which is in dilute sol state when injecting and filled in the whole plate space so that the plate can fully react. The GEL state electrolyte prevents leakage and layering;
- Low resistance PVC-SiO₂ micro-porous separator ensure low internal resistance;
- ABS containers and covers (FV0 optional)

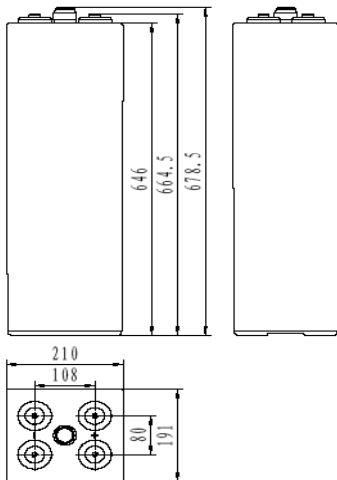

Application

- Renewable Energy;
- Energy utility: production, Transport, distribution, switchgear
- Telecom
- General electronic
- Mobility & leisure
- EPS/UPS

Compliant Standards

- IEC 60896-21/22 : 2004
- IEC 61427-2005
- DIN43539-T5 1984
- DIN40742:1999
- GB/T 22473-2008
- GB/T 22473-2008
- Passed ISO9001、ISO14001、OHSAS18001 certificate
- Eurobat guide;

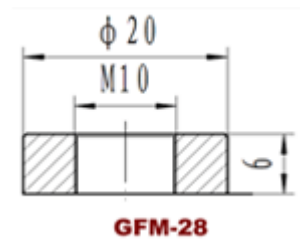

Battery Model	GFMJ-800H			
Designed Life	18 Years			
Capacity(25°C)	10HR(80A,1.80V)	5HR(136A,1.80V)	3HR(200A,1.80V)	1HR(400A,1.80V)
	800AH	680AH	600AH	400AH
Dimensions	Length	Width	Height	Total Height
	191mm	210mm	646mm	678.5mm
Approx. Weight	62kg			
Internal Resistance	0.4mΩ			
Max Discharge Current	3548A(3 Sec.)			
Self Discharge	≤3% per months (25°C)			
Charge Voltage(25°C)	Cycle use		Float use	
	2.33V(-3.5mV/°C), max charge current:160A		2.23V(-3.5mV/°C)	

Discharge parameter:

Constant current discharge data (25°C , A)																		
End voltage (V/cell)	5min	10min	15min	20min	30min	1h	2h	3h	5h	6h	8h	10h	20h	24h	48h	100h	120h	240h
1.65	1208	1080	944	820	696	460	302	235	162	136	106	93.2	48.1	40.5	20.8	10.3	8.72	4.48
1.70	1132	1012	876	760	676	440	284	223	153	130	102	88.2	48.1	40.5	20.8	10.3	8.72	4.48
1.75	1080	968	856	736	640	420	269	211	145	124	97.8	84.0	45.6	39.5	20.8	10.3	8.72	4.48
1.80	1020	920	812	680	616	400	254	200	136	117	94.0	80.0	43.2	39.5	20.8	10.3	8.72	4.48
1.85	960	868	768	640	580	380	241	189	130	112	89.0	75.6	40.8	37.6	20.8	10.3	8.72	4.48

Constant power discharge data (25°C , W/cell)																		
End voltage (V/cell)	5min	10min	15min	20min	30min	1h	2h	3h	5h	6h	8h	10h	20h	24h	48h	100h	120h	240h
1.65	2281	2039	1980	1720	1460	940	674	472	305	292	241	180	90.0	80.0	53.6	27.6	24.2	12.9
1.70	2068	1848	1778	1542	1372	912	660	456	300	283	232	174	90.0	80.0	53.6	27.6	24.2	12.9
1.75	1904	1707	1677	1442	1254	888	642	441	296	274	224	168	90.0	80.0	53.6	27.6	24.2	12.9
1.80	1663	1500	1471	1232	1116	832	628	424	288	264	216	164	88.0	80.0	53.6	27.6	24.2	12.9
1.85	1442	1304	1282	1068	968	812	596	402	275	251	207	155	83.2	75.6	53.6	27.6	24.2	12.9

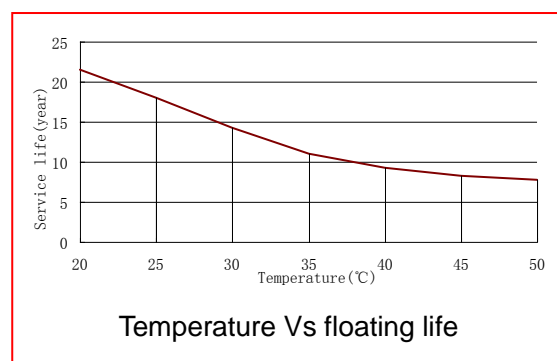
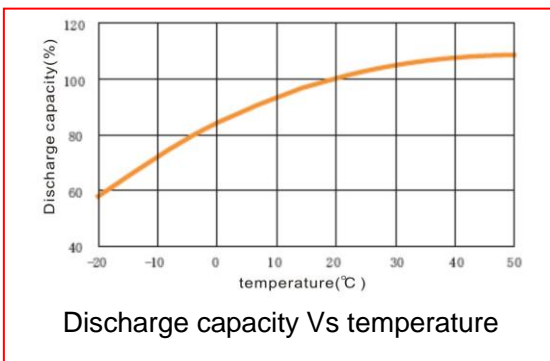
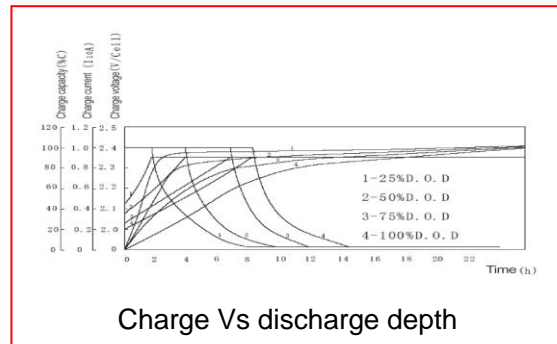
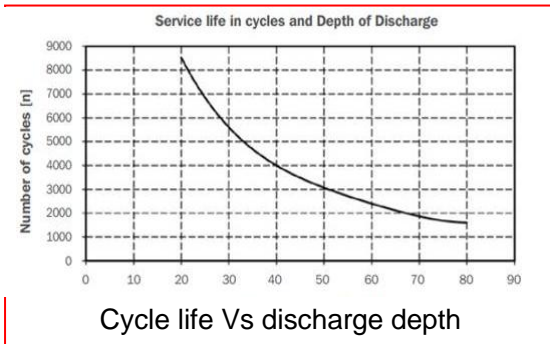
Performance Curve:

Address: NO.1 Shengyang Road, Qufu, Shandong 273100 China

Tel: +86-537-4438666-6028

Fax: +86-537-4411936

E-mail: sales@sacredsun.cn

<http://www.sacredsun.com>