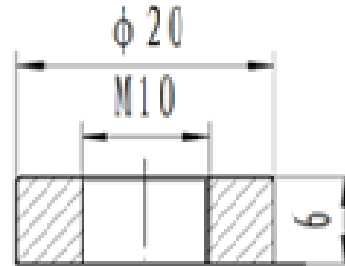
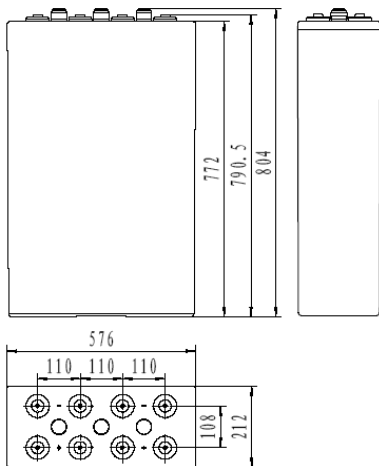

Product Features

- Tubular positive plate avoids active material from shedding effectively and the positive frame is cast by multi-alloy(Pb-Ca-Sn-Al) with fine and compact crystal structure, resulting in good corrosion resistance;
- Sulfuric acid immobilized as a gel using the gaseous SiO₂ as main electrolyte, which is in dilute sol state when injecting and filled in the whole plate space so that the plate can fully react. The GEL state electrolyte prevents leakage and layering;
- Low resistance PVC-SiO₂ micro-porous separator ensure low internal resistance;
- ABS containers and covers (FV0 optional)

GFM-28
Application

- Renewable Energy;
- Energy utility: production, Transport, distribution, switchgear
- Telecom
- General electronic
- Mobility & leisure
- EPS/UPS

Compliant Standards

- IEC 60896-21/22 : 2004
- IEC 61427-2005
- DIN43539-T5 1984
- DIN40742:1999
- GB/T 22473-2008
- GB/T 22473-2008
- Passed ISO9001, ISO14001, OHSAS18001 certificate
- Eurobat guide;

Battery Model	GFMJ-3000H			
Designed Life	18 Years			
Capacity(25°C)	10HR(300A,1.80V)	5HR(510A,1.80V)	3HR(750A,1.80V)	1HR(1500A,1.80V)
	3000AH	2550AH	2250AH	1500AH
Dimensions	Length	Width	Height	Total Height
	576mm	212mm	772mm	804mm
Approx. Weight	222kg			
Internal Resistance	0.12mΩ			
Max Discharge Current	12420A(3 Sec.)			
Self Discharge	≤3% per months (25°C)			
Charge Voltage(25°C)	Cycle use		Float use	
	2.33V(-3.5mV/°C), max charge current:600A		2.23V(-3.5mV/°C)	

Discharge parameter:

Constant current discharge data (25°C , A)																		
End voltage (V/cell)	5min	10min	15min	20min	30min	1h	2h	3h	5h	6h	8h	10h	20h	24h	48h	100h	120h	240h
1.65	3851	3443	3009	2614	2219	1725	1135	883	608	510	398	350	181	152	78.0	38.8	32.8	16.80
1.70	3608	3226	2792	2423	2155	1650	1065	838	575	486	383	330	181	152	78.0	38.8	32.8	16.80
1.75	3443	3086	2729	2346	2040	1575	1008	793	545	457	368	315	171	148	78.0	38.8	32.8	16.80
1.80	3251	2933	2588	2168	1964	1500	955	750	510	428	353	300	162	143	78.0	38.8	32.8	16.80
1.85	3060	2767	2448	2040	1849	1425	903	710	490	411	335	283	153	136	78.0	38.8	32.8	16.80

Constant power discharge data (25°C , W/cell)																		
End voltage (V/cell)	5min	10min	15min	20min	30min	1h	2h	3h	5h	6h	8h	10h	20h	24h	48h	100h	120h	240h
1.65	7698	6881	6685	5805	4928	3525	2528	1770	1143	1095	902.5	677.5	337.5	300.0	201.0	103.5	90.8	48.3
1.70	6936	6239	6001	5206	4631	3420	2475	1710	1128	1060	870.0	655.0	337.5	300.0	201.0	103.5	90.8	48.3
1.75	6242	5762	5661	4867	4232	3330	2408	1655	1113	1028	842.5	630.0	337.5	300.0	201.0	103.5	90.8	48.3
1.80	5438	5063	4966	4158	3767	3120	2355	1590	1080	990	810.0	615.0	330.0	300.0	201.0	103.5	90.8	48.3
1.85	4685	4399	4325	3605	3267	3045	2235	1510	1033	943	775.0	580.0	312.5	282.5	201.0	103.5	90.8	48.3

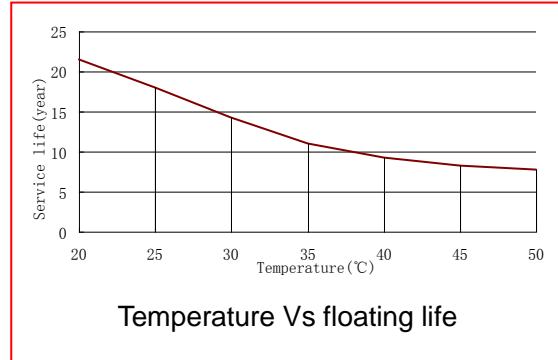
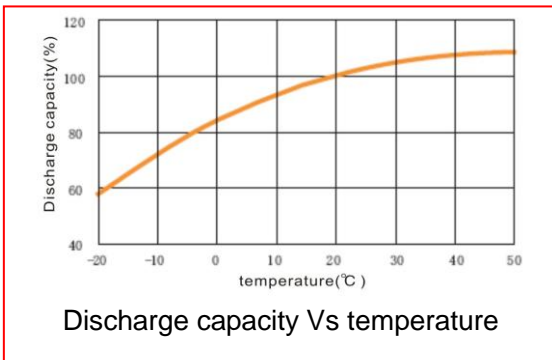
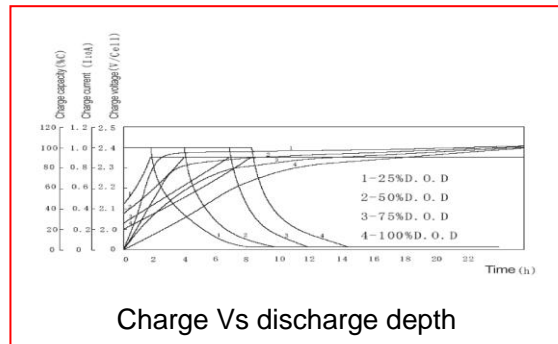
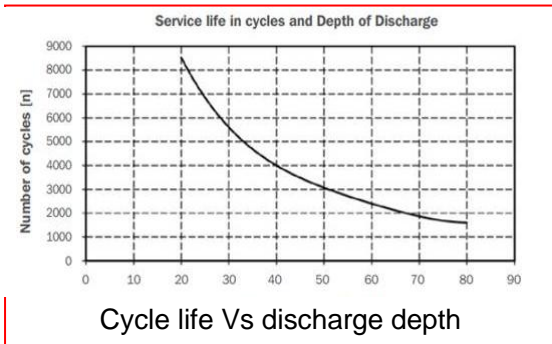
Performance Curve:

Address: NO.1 Shengyang Road, Qufu, Shandong 273100 China

Tel: +86-537-4438666-6028

Fax: +86-537-4411936

E-mail: sales@sacredsun.cn

<http://www.sacredsun.com>