

Product Features

- Patent composite grid structure, a smaller plate spacing design which provide high current discharge performance and high power output
- Special wide-low type structure effectively prevent electrolyte stratification;
- Optimization for positive and negative active material ratio, battery has high power ratio;
- ABS containers and covers (FV0 optional)

Application

- UPS/EPS
- Telecom;;
- Emergency lighting
- CATV
- Energy utility: production, Transport, distribution, switchgear;
- General electronic

Compliant Standards

- GB/T 19638.2-2005
- IEC 60896-21/22: 2004
- Passed ISO9001、ISO14001、OHSAS18001、UL and CE certificate
- Eurobat guide;

Safety

- installation compliant with:EN50272-2

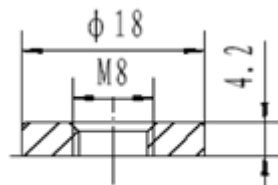
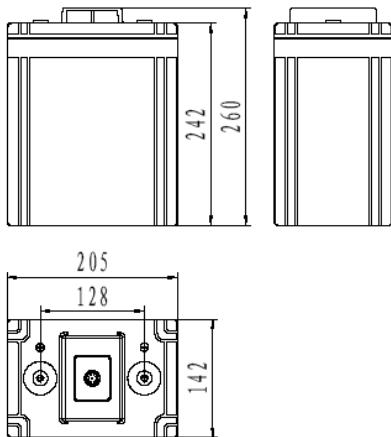

GFM-30

Battery Model	GFMG-275			
Designed Life	12 Years			
Capacity(25°C)	10HR(27.5A,1.80V)	5HR(48.2A,1.80V)	3HR(72.2A,1.80V)	1HR(165A,1.75V)
	275AH	241AH	216.6AH	165AH
Dimensions	Length	Width	Height	Total Height
	142mm	205mm	242mm	260mm
Approx. Weight	18.1kg			
Internal Resistance	0.52mΩ for fully charged battery at 25°C Test instrumentation: HIOKI 3551 BATTERY HITESTER			
Max Discharge Current	1500A(5 Sec.)			
Self Discharge	≤1% per months (25°C)			
Charge Voltage(25°C)	Cycle use		Float use	
	2.35V(-3.5mV/°C), max charge current:41.25A		2.25V(-3.5mV/°C)	

Discharge parameter:

Constant current discharge data (25°C, A)																		
End voltage (V/cell)	min							h										
	5	10	15	20	30	40	50	1	1.5	2	3	4	5	6	7	8	9	10
1.60	751	571	465	394	303	245	205	175	133	107	76.9	60.7	50.5	43.5	38.1	34.9	31.0	28.5
1.65	683	523	430	367	286	234	197	172	130	105	75.8	60.0	49.9	43.1	37.8	34.6	30.7	28.2
1.70	623	480	398	342	269	222	188	167	127	104	74.7	59.2	49.4	42.7	37.5	34.3	30.4	28.0
1.75	545	442	374	326	260	216	184	165	125	102	73.5	58.4	48.7	42.1	37.2	34.0	30.1	27.8
1.80	479	409	353	311	250	209	178	158	121	99.3	72.2	57.6	48.2	41.6	36.7	33.6	29.8	27.5

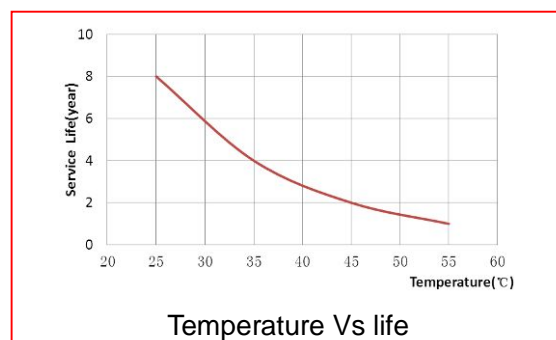
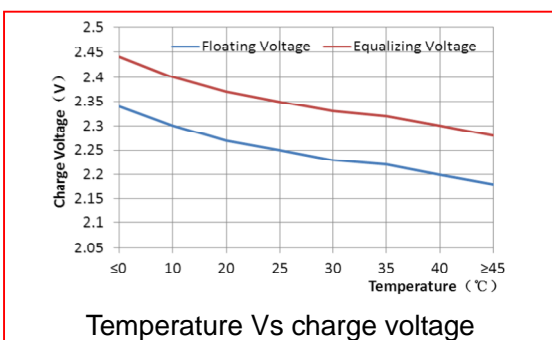
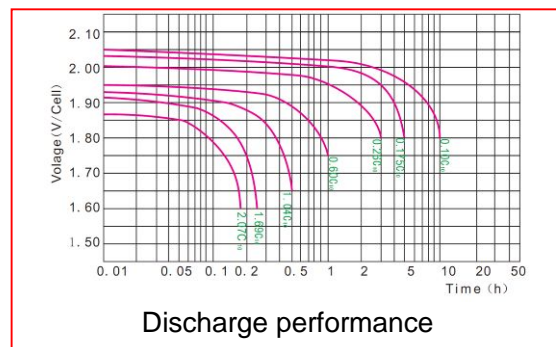
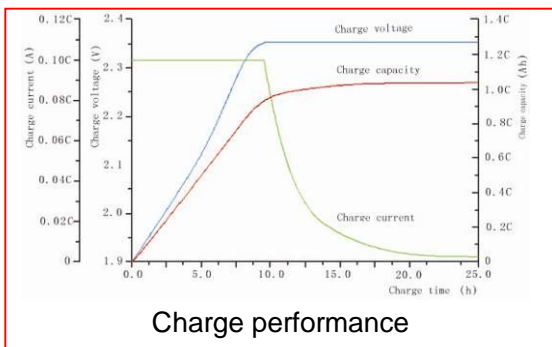
Constant power discharge data (25°C, W/cell)																		
End voltage (V/cell)	min							h										
	5	10	15	20	30	40	50	1	1.5	2	3	4	5	6	7	8	9	10
1.60	1094	926	768	669	510	413	353	309	238	195	141	111	93.4	81.3	72.7	67.2	60.1	54.8
1.65	1005	841	704	617	474	389	335	298	229	188	137	109	91.8	79.7	71.7	66.4	59.2	53.8
1.70	887	770	655	577	442	369	317	289	223	183	134	107	90.6	78.7	70.8	65.6	58.5	53.3
1.75	795	712	610	537	414	347	303	276	217	178	131	105	88.9	77.7	70.0	64.7	57.6	52.6
1.80	730	653	559	494	389	328	292	263	210	174	129	103	87.3	76.5	68.8	63.9	56.8	51.8

Performance Curve:

Address: NO.1 Shengyang Road, Qufu, Shandong 273100 China

Tel: +86-537-4438666-6028

Fax: +86-537-4411936

E-mail: sales@sacredsun.cn

http://www.sacredsun.com