

### Product Features

- Narrow width design with 2\*3 cell structure, front terminal is convenient for installation, front centralized exhaust system design, suitable for 19' and 23' power supply cabinet;
- Radial grid design, good large current discharge performance; thick pasted active substance for long service life;
- Particular thin and thick fire matching AGM separator, enhance electrolyte adsorbed volume, battery has high temperature performance, suitable for outdoor using.
- ABS containers and covers (FV0 optional)
- Gaz pipe systems (optional)

### Application

- International standard 19' and 23' cabinet;
- Telecom
- power supply system
- EPS/UPS

### Compliant Standards

- IEC 60896-21/22: 2004
- BS 6290-4:1997
- YD/T2343-2011
- Passed ISO9001、ISO14001、OHSAS18001、UL and CE certificate
- Eurobat guide;

### Safety

- installation compliant with:EN50272-2

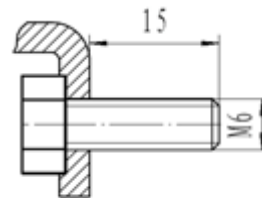
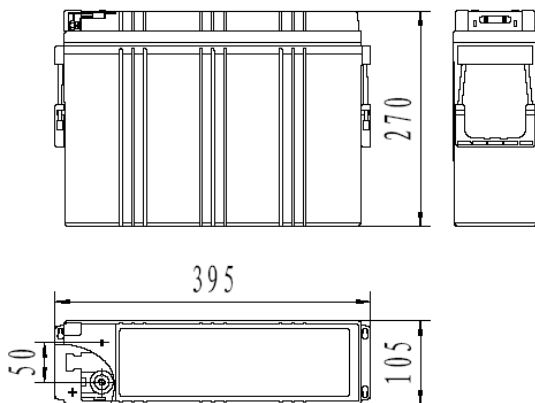

**FT-54**

Battery Model	FTB12-95			
Designed Life	12 Years			
Capacity(25°C)	10HR(9.5A,1.80V)	5HR(17.6A,1.80V)	3HR(24.8A,1.80V)	1HR(62.8A,1.75V)
	95AH	88AH	74.4AH	62.8AH
Dimensions	Length	Width	Height	Total Height
	395mm	105mm	270mm	270mm
Approx. Weight	28.5kg			
Internal Resistance	4.8mΩ			
Maximum Discharge Current	799A(3 Sec.)			
Self Discharge	≤1.5% per months (25°C)			
Charge Voltage(25°C)	Cycle use			Float use
	14.4V(-21mV/°C), max charge current:19A			13.62V(-21mV/°C)

**Discharge parameter:**

Constant current discharge data (25°C, A)														
End voltage (V/cell)	5min	10min	15min	30min	45min	1h	2h	3h	4h	5h	6h	8h	10h	20h
1.60	366	246	188	115	83.5	65.9	36.8	25.9	20.1	18.4	14.1	11.5	9.6	5.28
1.65	323	236	183	112	82	65.1	36.5	25.8	20.0	18.3	14.1	11.3	9.6	5.22
1.70	298	224	175	109	80.5	63.8	36.4	25.4	19.9	18.0	14.0	11.2	9.6	5.10
1.75	278	212	168	106	78.5	62.8	35.8	25.2	19.8	17.8	13.9	11.2	9.5	5.10
1.80	255	200	160	102	76.1	61.5	35.5	24.8	19.7	17.6	13.9	11.1	9.5	5.03

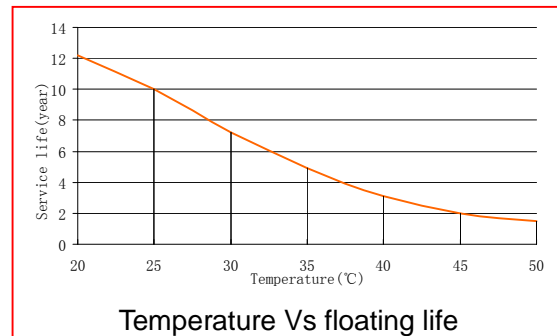
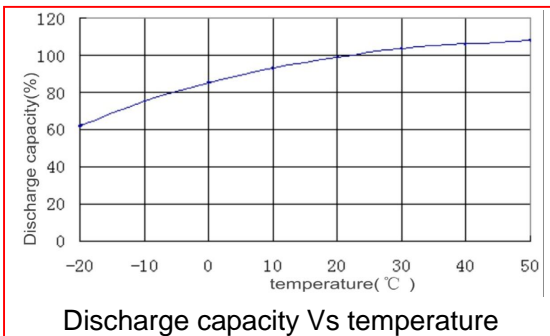
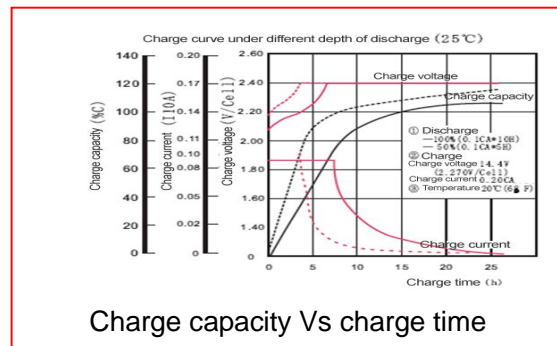
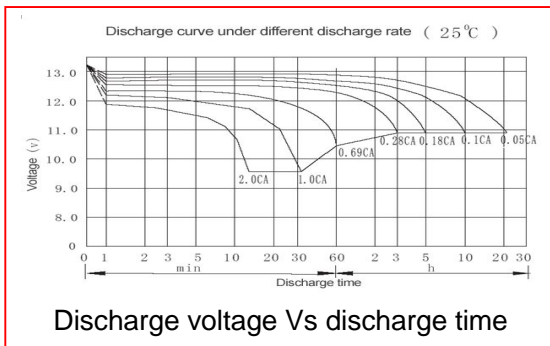
Constant power discharge data (25°C, W/cell)														
End voltage (V/cell)	5min	10min	15min	30min	45min	1h	2h	3h	4h	5h	6h	8h	10h	20h
1.60	615	444	346	216	160	128	72.5	49.3	40.2	35.2	28.3	22.8	18.9	10.6
1.65	556	429	339	212	158	125	72	49.2	40.0	35.2	28.3	22.8	18.8	10.5
1.70	531	415	320	207	155	123.0	71.2	48.8	35.6	34.8	28.1	22.6	18.7	10.4
1.75	506	395	314	203	152	122	70.7	48.5	39.8	34.5	28.0	22.5	18.6	10.3
1.80	485	373	301	196	148	120	70.1	48.2	39.5	34.3	27.9	22.4	18.4	10.1

**Performance Curve:**

ISO9001 ISO14001 OHSAS18001

Address: NO.1 Shengyang Road, Qufu, Shandong 273100 China

Tel: +86-537-4438666-6028

Fax: +86-537-4411936

E-mail: sales@sacredsun.cn

http://www.sacredsun.com