

Product Features

- Narrow width design with 2*3 cell structure, front terminal is convenient for installation, front centralized exhaust system design, suitable for 19' and 23' power supply cabinet;
- Radial grid design, good large current discharge performance; thick pasted active substance for long service life;
- Particular thin and thick fire matching AGM separator, enhance electrolyte adsorbed volume, battery has high temperature performance, suitable for outdoor using.
- ABS containers and covers (FV0 optional)
- Gaz pipe systems (optional)

Application

- International standard 19' and 23' cabinet;
- Telecom
- power supply system
- EPS/UPS

Compliant Standards

- IEC 60896-21/22: 2004
- BS 6290-4:1997
- YD/T2343-2011
- Passed ISO9001、ISO14001、OHSAS18001、UL and CE certificate
- Eurobat guide;

Safety

- installation compliant with:EN50272-2

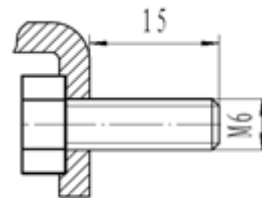
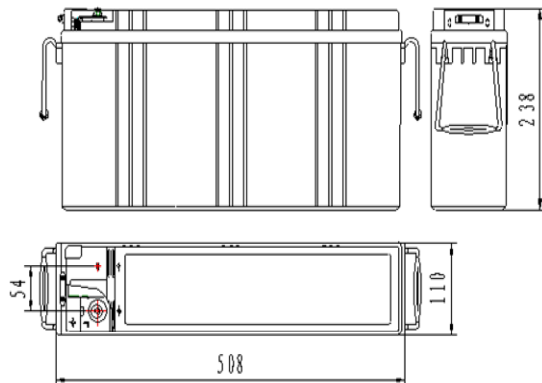

FT-54

Battery Model	FTB12-105			
Designed Life	12 Years			
Capacity(25°C)	10HR(10.5A,1.80V)	5HR(18.4A,1.80V)	3HR(28.8A,1.80V)	1HR(64.6A,1.75V)
	105AH	92AH	86.4AH	64.6AH
Dimensions	Length	Width	Height	Total Height
	508mm	110mm	238mm	238mm
Approx. Weight	35.4kg			
Internal Resistance	4.1mΩ			
Maximum Discharge Current	938A(3 Sec.)			
Self Discharge	≤1.5% per months (25°C)			
Charge Voltage(25°C)	Cycle use		Float use	
	14.4V(-21mV/°C), max charge current:21A		13.62V(-21mV/°C)	

Discharge parameter:

Constant current discharge data (25°C, A)														
End voltage (V/cell)	5min	10min	15min	30min	45min	1h	2h	3h	4h	5h	6h	8h	10h	20h
1.60	350	257	199	122	86.9	69.8	41.9	30.7	23.2	19.3	16.5	12.4	10.8	5.60
1.65	331	238	188	114	84.0	68.4	41.4	30.1	23.0	19.1	16.4	12.4	10.7	5.60
1.70	307	223	178	110	81.1	67.0	40.4	29.5	22.7	18.9	16.2	12.3	10.6	5.50
1.75	289	203	161	104	77.8	64.6	40.0	29.2	22.5	18.6	16.0	12.3	10.6	5.50
1.80	274	185	152	100	74.7	62.2	39.4	28.8	22.3	18.4	15.8	12.1	10.5	5.50

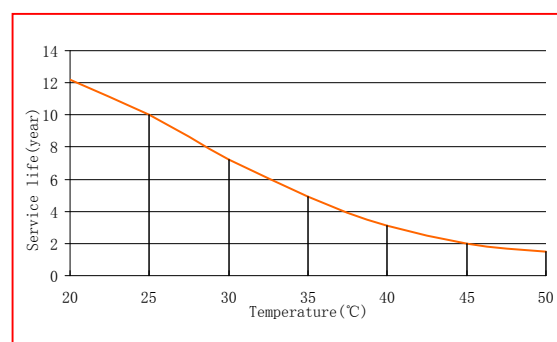
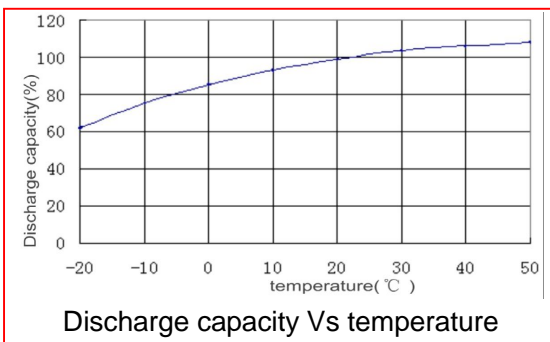
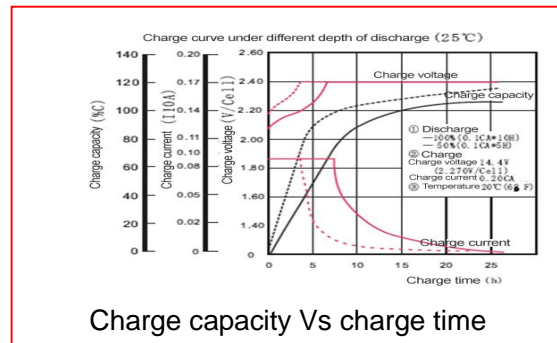
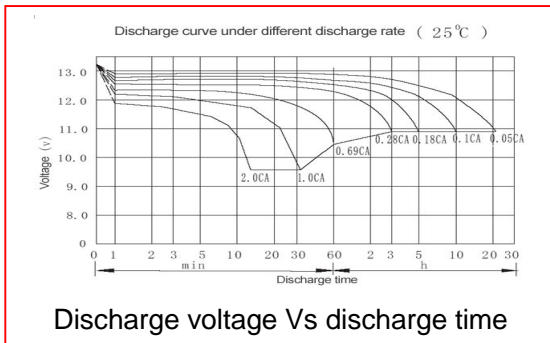
Constant power discharge data (25°C, W/cell)														
End voltage (V/cell)	5min	10min	15min	30min	45min	1h	2h	3h	4h	5h	6h	8h	10h	20h
1.60	570	430	348	226	163	132	79.2	58.3	44.4	36.8	31.7	23.8	20.8	10.86
1.65	556	410	335	215	159	130	78.6	57.5	44.1	36.6	31.5	23.8	20.8	10.86
1.70	535	395	324	208	154	128	77.6	56.7	43.9	36.4	31.2	23.8	20.8	10.86
1.75	521	370	302	198	149	124	77.1	56.2	43.6	36.1	31.0	23.8	20.8	10.86
1.80	506	348	288	190	143	120	76.2	55.8	43.3	35.8	30.7	23.5	20.6	10.86

Performance Curve:

ISO9001 ISO14001 OHSAS18001

Address: NO.1 Shengyang Road, Qufu, Shandong 273100 China

Tel: +86-537-4438666-6028

Fax: +86-537-4411936

E-mail: sales@sacredsunsun.cn

http://www.sacredsunsun.com