

Product Features

- Larger capacity, thick plate structural design, long battery life;
- Horizontal installation method effectively prevent electrolyte stratification;
- Multi layer stacking, modular structure design is convenient for installation and maintenance, effectively save space;

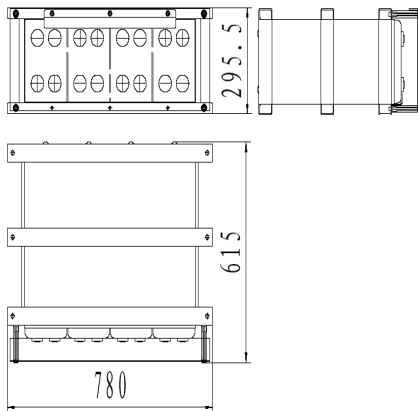

Application

- Telecom
- Emergency lighting
- General electronic
- Energy utility: production, Transport, distribution, switchgear
- Renewable Energy;
- EPS/UPS

Compliant Standards

- GB/T 19638.2-2005
- YD/T 799-2010
- DL/T 637-1997
- IEC 60896-21/22: 2004
- Passed ISO9001、ISO14001、OHSAS18001、UL and CE certificate
- Eurobat guide;

Safety

- installation compliant with:EN50272-2

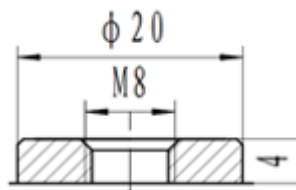

GFM-26

Battery Module	4GFM-800H			
Battery pcs per module	4 Pcs per module			
Designed Life	18 Years			
Capacity(25℃)	10HR(80A,1.80V)	5HR(136A,1.80V)	3HR(200A,1.80V)	1HR(440A,1.75V)
	800AH	680AH	600AH	440AH
Dimensions	Depth	Width	Height	Total Height
	615mm	780mm	295.5mm	295.5mm
Approx. Weight	238.3kg			
Internal Resistance	0.36m Ω per battery for fully charged battery at 25℃ Test instrumentation: HIOKI 3551 BATTERY HITESTER			
Max Discharge Current	3600A(5 Sec.)			
Self Discharge	≤ 1% per months (25℃)			
Charge Voltage(25℃)	Cycle use		Float use	
	2.35V(-3.5mV/℃), max charge current:120A		2.25V(-3.5mV/℃)	

Discharge parameter:

Constant current discharge data (25°C, A)																			
End voltage (V/cell)	min							h											
	5	10	15	20	30	40	50	1	1.5	2	3	4	5	6	7	8	9	10	24
1.60	1117	992	924	868	754	619	521	471	345	290	213	169	143	125	112	102	92.0	83.1	37.8
1.65	1031	919	870	808	695	580	497	457	340	282	208	167	141	124	111	101	90.5	82.4	37.2
1.70	955	866	824	754	636	545	478	447	335	273	206	165	139	122	110	99.4	89.8	81.7	36.5
1.75	890	818	778	705	587	515	465	440	330	269	203	163	138	121	108	98.5	88.9	80.9	35.9
1.80	801	761	725	663	551	486	443	414	323	265	200	161	136	120	107	97.6	88.1	80.0	35.2

Constant power discharge data (25°C, W/cell)																			
End voltage (V/cell)	min							h											
	5	10	15	20	30	40	50	1	1.5	2	3	4	5	6	7	8	9	10	24
1.60	1771	1672	1560	1437	1219	1055	932	866	676	555	407	329	279	244	219	198	180	165	78.1
1.65	1653	1560	1460	1344	1153	1005	899	842	659	541	399	321	274	238	214	194	177	162	77.1
1.70	1543	1453	1353	1249	1091	963	866	822	644	527	390	314	267	234	209	190	173	160	76.1
1.75	1447	1362	1277	1179	1030	923	843	804	628	514	380	306	260	228	205	186	170	157	75.0
1.80	1333	1263	1187	1103	982	885	819	783	615	500	372	299	254	223	200	182	167	154	74.1

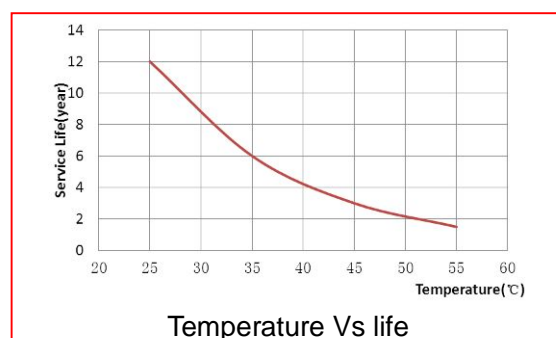
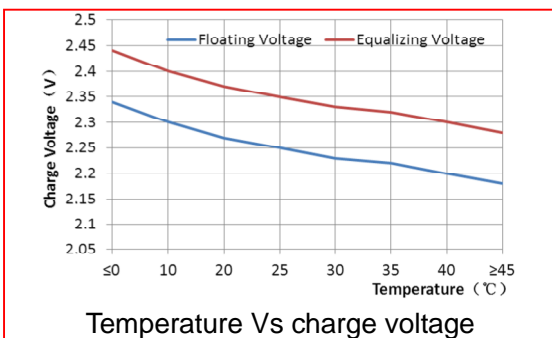
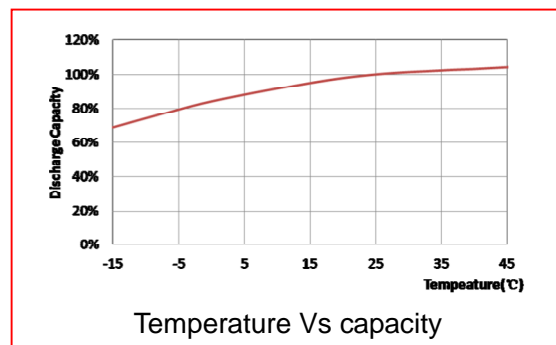
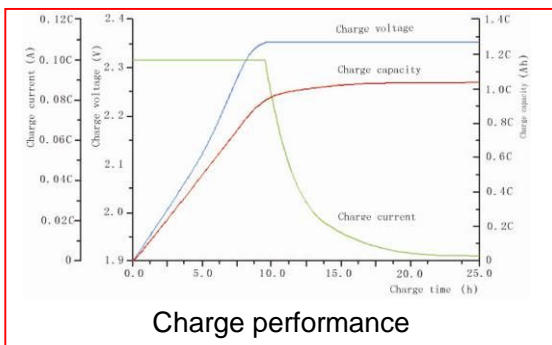
Performance Curve:

Address: NO.1 Shengyang Road, Qufu, Shandong 273100 China

Tel: +86-537-4438666-6028

Fax: +86-537-4411936

E-mail: sales@sacredsun.cn

<http://www.sacredsun.com>