

Product Features

- Patent composite grid structure, a smaller plate spacing design which provide high current discharge performance and high power output
- Special wide-low type structure effectively prevent electrolyte stratification;
- Optimization for positive and negative active material ratio, battery has high power ratio;
- ABS containers and covers (FV0 optional)

Application

- UPS/EPS;
- Telecom;
- Emergency lighting;
- CATV;
- Energy utility: production, Transport, distribution; switchgear;
- General electronic.

Compliant Standards

- GB/T 19638.2-2005
- IEC 60896-21/22: 2004
- Passed ISO9001、ISO14001、OHSAS18001、UL and CE certificate
- Eurobat guide;

Safety

- installation compliant with:EN50272-2

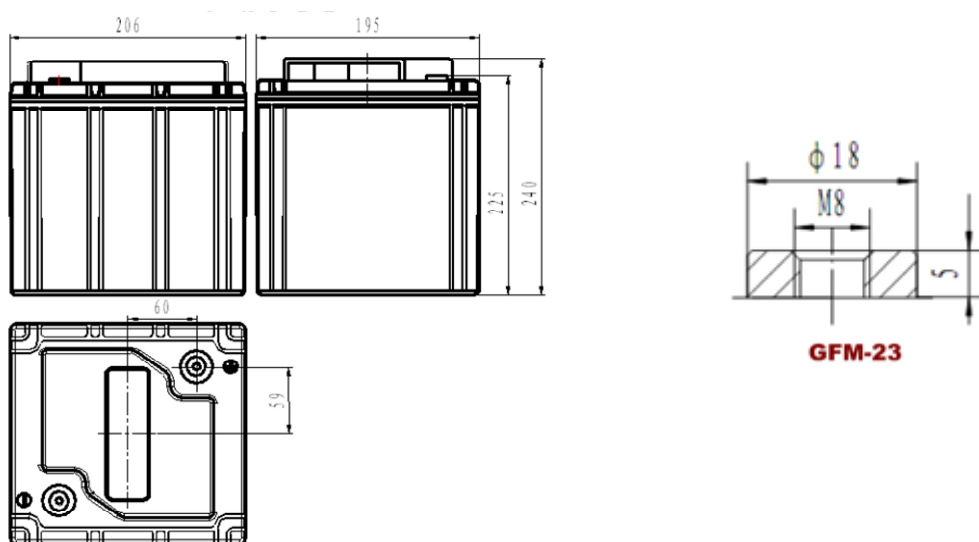

Battery Model	3GFMG-105			
Designed Life	12 Years			
Capacity(25°C)	10HR(10.5A,1.80V)	5HR(17.13A,1.80V)	3HR(26.63A,1.80V)	1HR(65.59A,1.75V)
	105AH	85.65AH	79.89AH	65.59AH
Dimensions	Length	Width	Height	Total Height
	195mm	206mm	220mm	240mm
Approx. Weight	22.4kg			
Internal Resistance	2.62mΩ for fully charged battery at 25°C Test instrumentation: HIOKI 3551 BATTERY HITESTER			
Max Discharge Current	945A(5 Sec.)			
Self Discharge	≤1% per months (25°C)			
Charge Voltage(25°C)	Cycle use		Float use	
	2.35V/cell(-3.5mV/°C), max charge current:21A		2.25V/cell(-3.5mV/°C)	

Discharge parameter:

Constant current discharge data (25°C, A)																		
End voltage (V/cell)	min							h										
	5	10	15	20	30	40	50	1	1.5	2	3	4	5	6	7	8	9	10
1.60	316.0	254.8	210.0	171.7	125.0	107.7	80.0	68.50	56.05	45.31	28.35	23.15	18.90	16.31	14.43	12.86	11.75	10.88
1.65	290.3	239.6	197.7	163.4	121.0	104.6	78.4	67.56	55.25	44.63	27.93	22.74	18.47	16.07	14.25	12.75	11.65	10.79
1.70	261.0	223.4	188.3	153.6	116.2	100.8	76.5	66.53	54.33	43.78	27.57	22.34	18.02	15.84	14.07	12.62	11.54	10.69
1.75	239.8	207.6	174.9	146.3	111.4	97.1	74.6	65.59	53.47	42.97	27.08	21.88	17.57	15.57	13.88	12.50	11.43	10.60
1.80	222.0	192.5	166.2	138.4	106.4	93.2	72.6	64.50	52.45	41.99	26.63	21.44	17.13	15.30	13.69	12.38	11.33	10.50

Constant power discharge data (25°C, W/cell)																		
End voltage (V/cell)	min							h										
	5	10	15	20	30	40	50	1	1.5	2	3	4	5	6	7	8	9	10
1.60	537.0	430.0	353.0	293.3	217.0	191.6	152.9	138.0	105.8	78.00	54.57	45.11	37.50	32.10	28.17	24.87	22.51	20.61
1.65	502.7	411.3	339.8	281.8	211.4	187.2	150.6	136.8	104.9	77.30	54.17	44.70	37.06	31.77	27.94	24.74	22.41	20.53
1.70	475.8	392.4	325.8	271.6	206.1	182.9	148.2	135.2	103.7	76.40	53.71	44.25	36.60	31.49	27.73	24.58	22.30	20.47
1.75	442.6	373.3	311.1	262.0	199.7	177.8	145.4	133.5	102.2	75.20	53.21	43.76	36.09	31.14	27.48	24.44	22.20	20.41
1.80	410.0	350.7	297.6	251.1	193.0	172.5	142.5	131.7	100.8	74.10	52.70	43.27	35.60	30.80	27.26	24.33	22.11	20.34

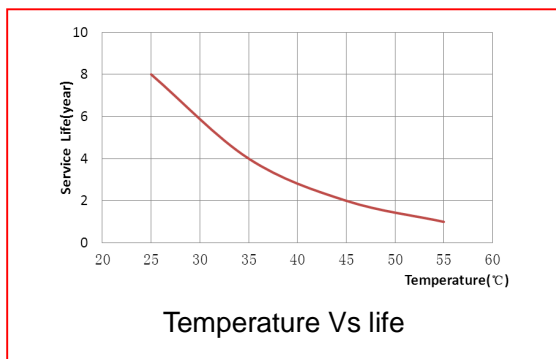
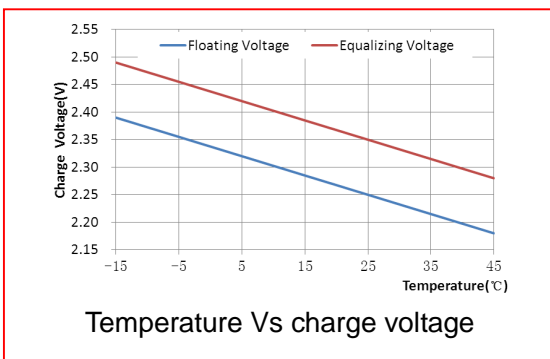
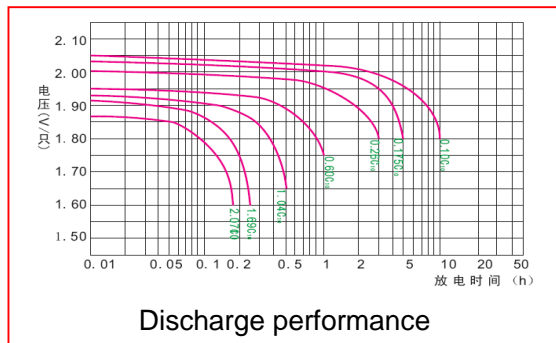
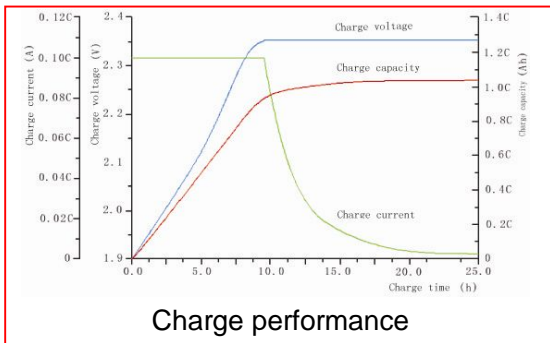
Performance Curve:

Address: NO.1 Shengyang Road, Qufu, Shandong 273100 China

Tel: +86-537-4438666-6028

Fax: +86-537-4411936

E-mail: sales@sacredsun.cn

<http://www.sacredsun.com>